

Service Manual

Cordless Band Saw

Model No. EY45A5

Europe
Oceania

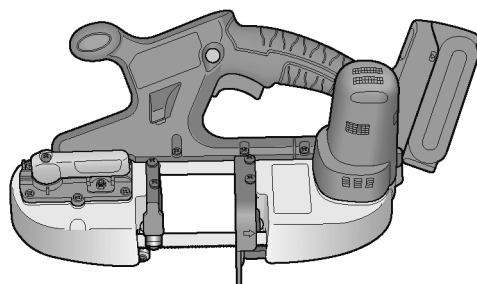

WARNING

This service information is designed for experienced repair technicians only and is not designed for use by the general public. It does not contain warnings or cautions to advise non-technical individuals of potential dangers in attempting to service a product. Products powered by electricity should be serviced or repaired only by experienced professional technicians. Any attempt to service or repair the product or products dealt with in this service information by anyone else could result in serious injury or death.

IMPORTANT SAFETY NOTICE

There are special components used in this equipment which are important for safety. These parts are marked by  in the Schematic Diagrams, Circuit Board Diagrams, Exploded Views and Replacement Parts List. It is essential that these critical parts should be replaced with manufacturer's specified parts to prevent shock, fire or other hazards. Do not modify the original design without permission of manufacturer.

TABLE OF CONTENTS

	PAGE	PAGE
1 Warning.....	2	
2 Specifications	2	
3 Troubleshooting Guide.....	3	
4 Disassembly and Assembly Instructions	5	
5 Exploded View and Replacement Parts List	13	

Panasonic

© Panasonic corporation 2017. All rights reserved.
Unauthorized copying and distribution is a violation of law.

1 Warning

Caution:

- Pb free solder has a higher melting point than standard solder; Typically the melting point is 50 - 70°F (30 - 40°C) higher. Please use a soldering iron with temperature control and adjust it to 750 ± 20°F (400 ± 10°C). In case of using high temperature soldering iron, please be careful not to heat too long.
- Pb free solder will tend to splash when heated too high (about 1100°F / 600°C).

2 Specifications

Model No.	EY45A5	
Motor voltage	DC 14.4 V	DC 18 V
Blade speed (no load)	Low: 110 m/min Mid: 120 m/min High: 130 m/min	Low: 120 m/min Mid: 140 m/min High: 162 m/min
Blade dimensions	Length 730 mm × Width 13 mm × Thickness 0.5 mm	
Maximum cutting capacity*	Round stock: external diameter 63.5 mm Rectangular stock: 56 mm × 63.5 mm (* Values for cutting a rotating workpiece.)	
Overall length	382 mm (main unit only)	
Weight (with battery pack: EY9L54)	4.05 kg	

3 Troubleshooting Guide

3.1. Troubleshooting Guide

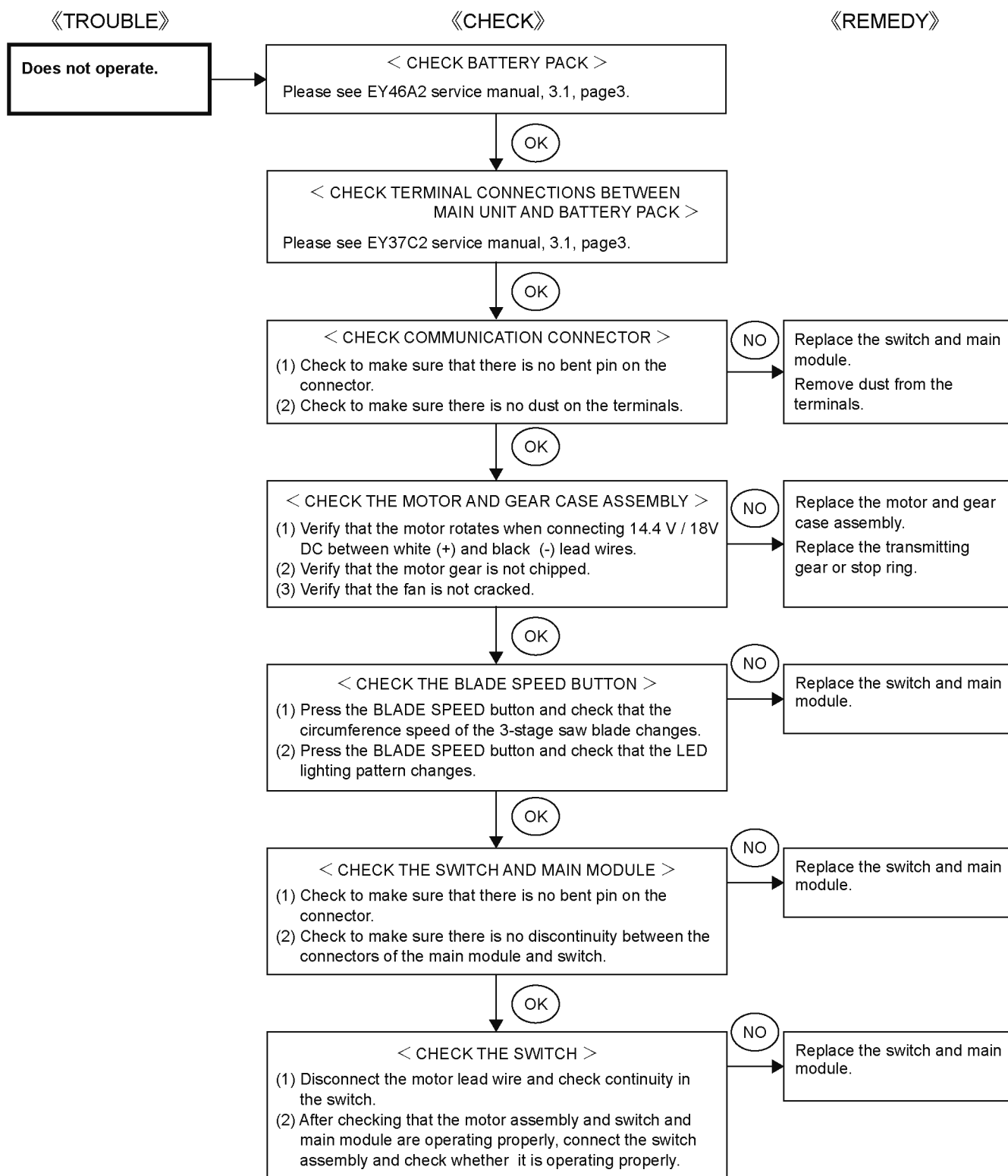

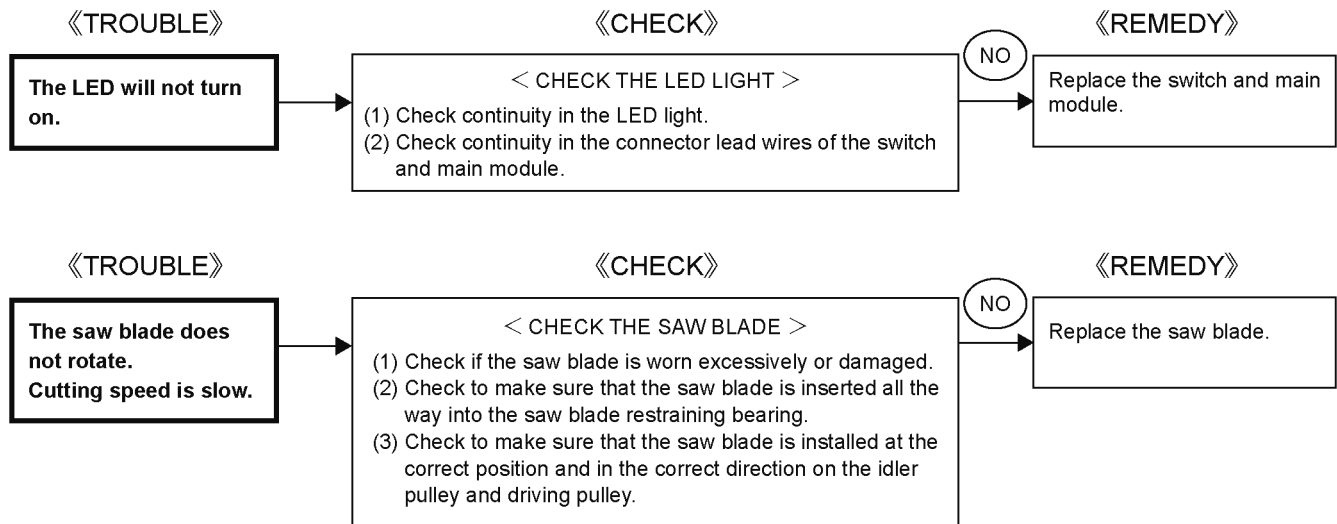

3.2. Trial Operation (after checking Troubleshooting Guide).

3.2.1. Assembly

- Confirm if there is no gap between housing A and B by pinching lead wires.
- There is no dust or deformation on battery terminals.
- Check to make sure that the saw blade is installed at the correct position.

3.2.2. Operation

- Make sure that the switch trigger cannot be pulled when the off-lock switch is not operated and that the trigger can be pulled when the off-lock switch is operated.
- Make sure that the LED turns off as soon as the switch trigger is released.
- Check the each time the blade speed button is pressed, the mode changes as follows: High mode → Middle mode → low mode → High mode.
- Mount the saw blade, and then operate the product for one minute using the 18-V battery pack to make sure that the blade will not detach.
- Operate the saw blade tension lever and make sure that the saw blade tension becomes tight or loose.
- Make sure that the upper/lower guard can be dismounted and remounted properly.
- Make sure that the saw blade operates smoothly and stably after the replacement.

3.2.3. Integrity

- With the switch activated, shake the tool back and forth and up and down and verify that its sound does not change excessively.
- Check for the presence of any dirt or foreign matter from the repair process on the outside of the tool.

4 Disassembly and Assembly Instructions

* To reduce the risk of injury, always remove battery pack before removing/attaching the saw blade.

* Be sure to wear protective leather gloves for safety when detaching/attaching the saw blade.

4.1. How to remove the Saw blade.

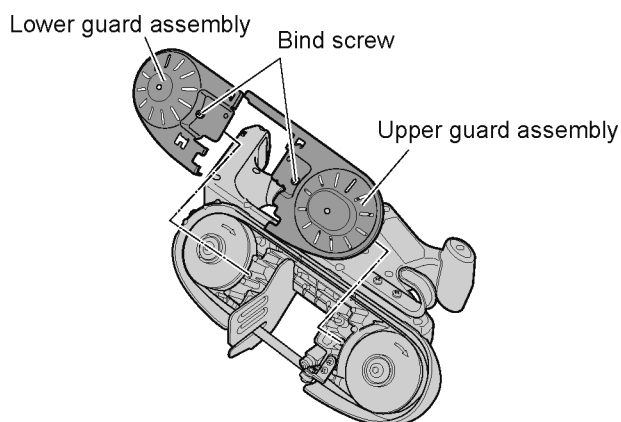

1. Remove 2 bind screws.
2. Remove the upper guard assembly and lower guard assembly.

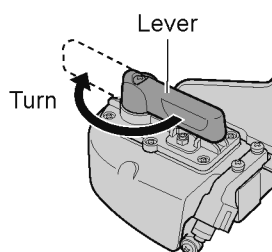

3. Rotate the lever 180 degrees clockwise (direction of the arrow), to release tension.

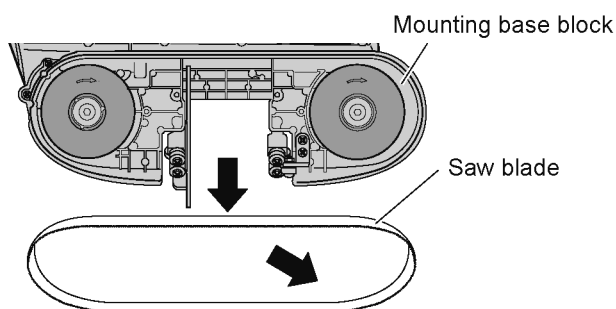

4. Carefully remove the saw blade.

*When attaching saw blade, rotate the lever 180 degrees anticlockwise.

*Precaution when attaching the saw blade.

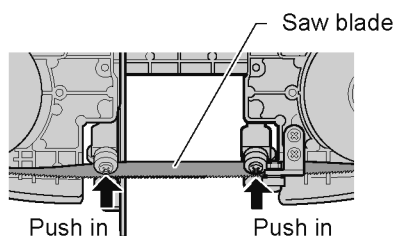

Be sure to push until the back of the saw blade contacts with the rear bearings of the saw blade restraining bearings (both).

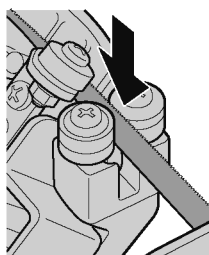

Be sure that the saw blade is parallel to the guide plate.

4.2. How to remove the Guide C assembly, Idler pulley and Driving pulley.

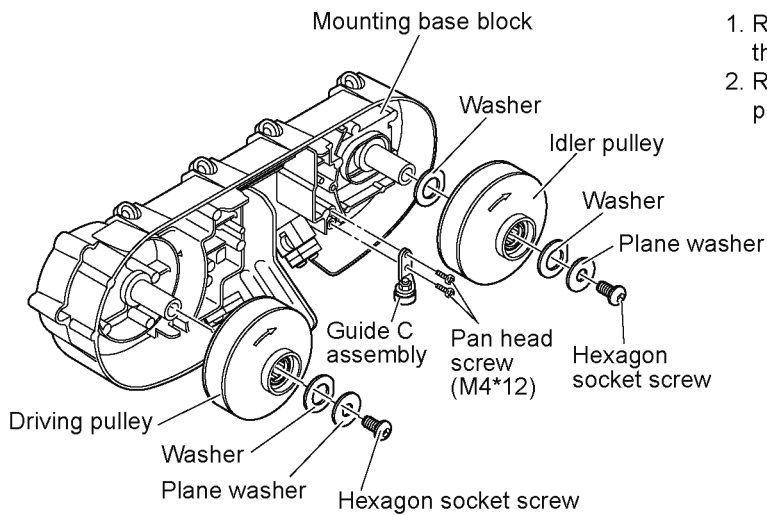

1. Remove the 2 pan head screws (M4*12) and remove the guide C assembly.
2. Remove the hexagon socket screw, washers, and plane washer and remove idler/driving pulley.

4.3. How to remove the Operation panel, Hook, and Housing B.

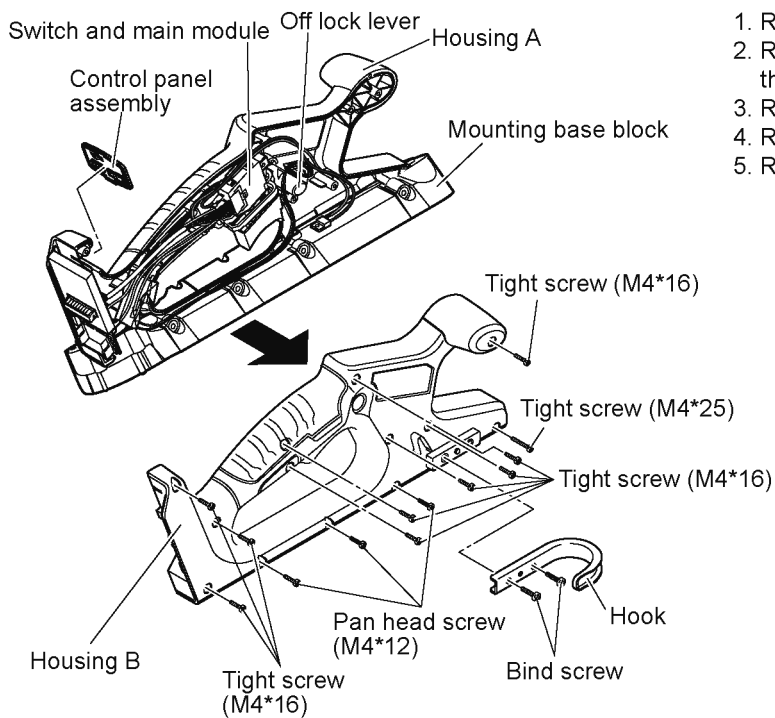

1. Remove the 2 bind screws and remove the hook.
2. Remove the 9 pan head screws (M4*16) and remove the hook.
3. Remove the 3 pan head screws (M4*12).
4. Remove the tight screw (M4*25).
5. Remove the control panel assembly and housing B.

4.4. How to remove the Switch and Main module.

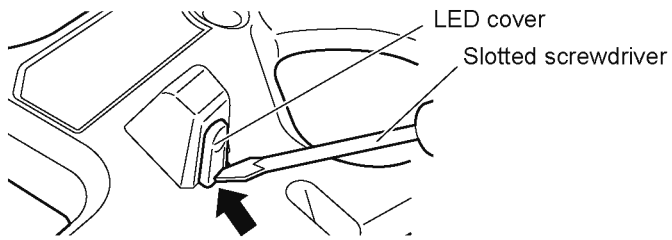

1. Press the base of the LED cover with a slotted screwdriver to disengage it from the claw on the housing, and then remove the LED cover and LED together.

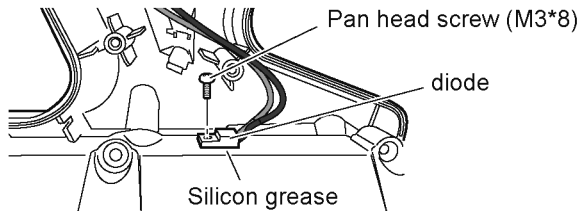

2. Remove the pen head screw (M3*8).
3. Remove the diode from the base block.
*Do not wipe off the silicone grease from the mounting base block.

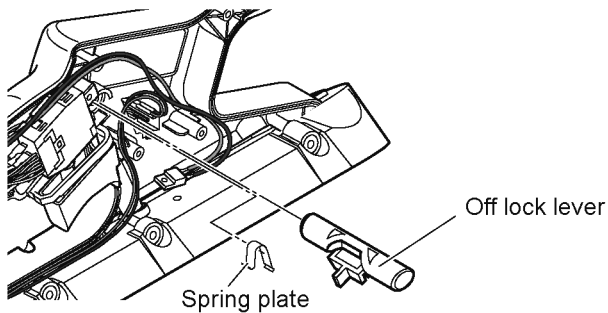

4. Dismount the switch from the housing A block, and remove the off-lock lever and spring plate at the same time.

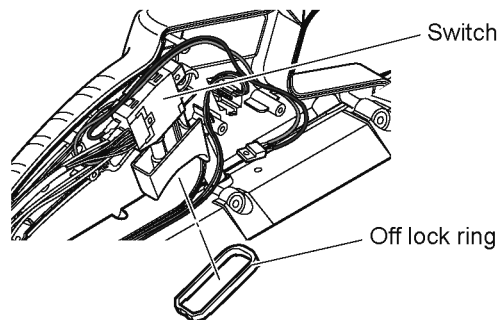

5. Remove the off lock ring from the switch.

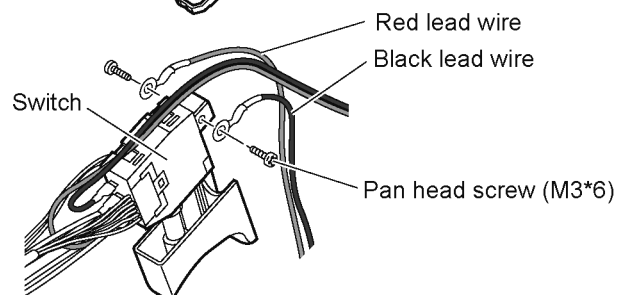

6. Remove the 2 pen head screws (M3*6).

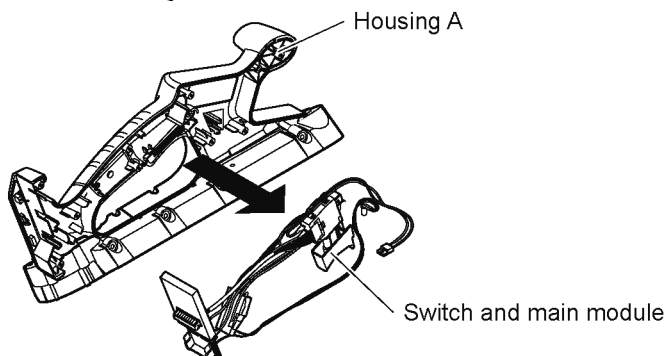

7. Remove the switch and main module from the housing A.

4.5. How to remove the Housing A, Guide A , Fence and Guide B.

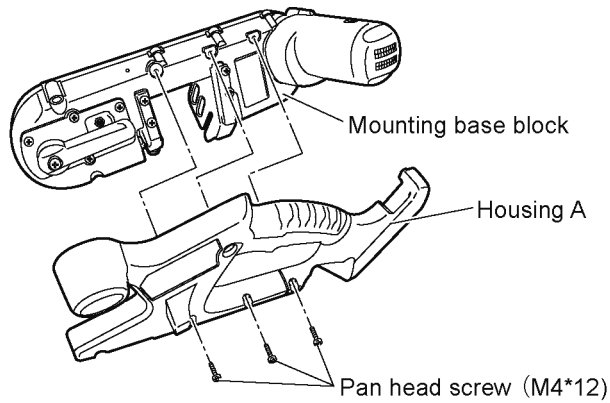

1. Remove the 3 pan head screws (M4*12) and remove the housing A from the mounting base block.

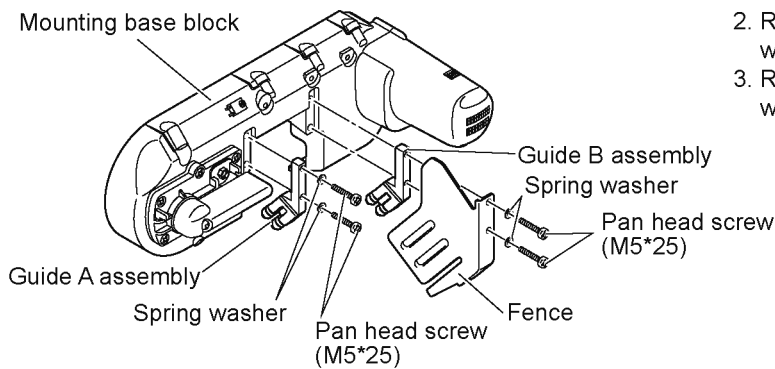

2. Remove the 2 pan head screws (M5*25) and 2 spring washers and remove the guide A assembly.
3. Remove the 2 pan head screws (M5*25) and 2 spring washers and remove the guide B assembly and fence.

4.6. How to remove the Motor case and Motor and Gear case assembly.

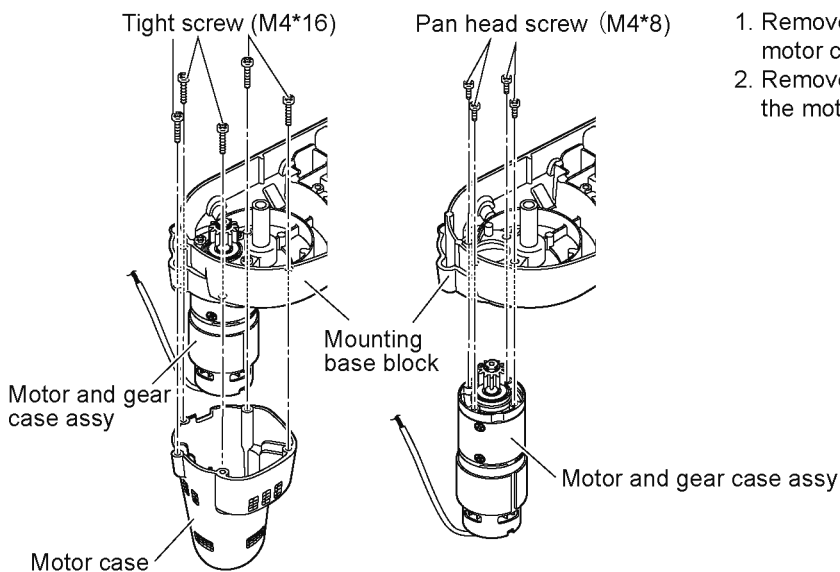

1. Remove the 5 tight screws (M4*16) and remove the motor case from the mounting base block.
2. Remove the 4 pan head screws (M4*8) and remove the motor and gear case assy.

4.7. How to remove the Lever and Cover plate assembly.

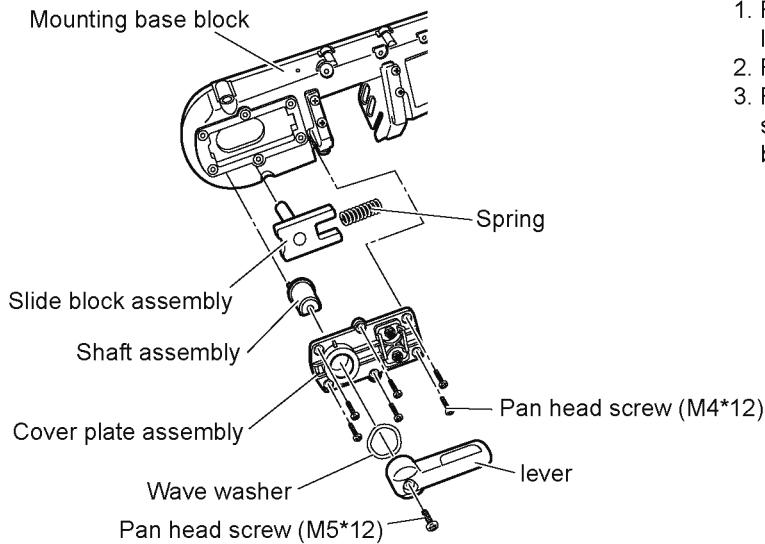

1. Remove the pan head screw (M5*12) and remove the lever and wave washer.
2. Remove the 6 pan head screws (M4*12).
3. Remove the cover plate assembly, shaft assembly, slide block assembly and spring from the mounting base block.

4.8. How to adjust the Pulley and blade positions during the replacement of the Cover plate assembly or Idler/Driving pulley.

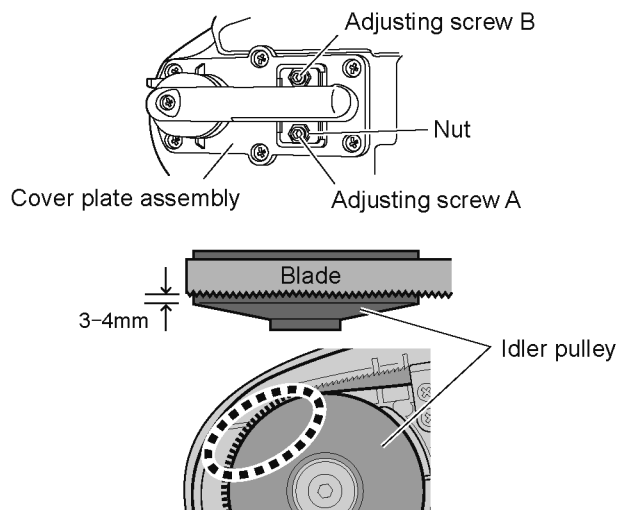

1. Loosen the 2 nuts on the adjusting screws A and B, and then loosen the adjusting screws A and B using a hexagon wrench.
2. Turn on the switch, and adjust the gap between the idler pulley side face and rotating blade.
 - Slowly tighten the adjusting screw A until the blade tip is positioned about 3 to 4 mm inside of the pulley side face.
 - Slowly tighten the adjusting screw B until load is generated.
3. Tighten the 2 nuts to prevent the adjusting screws A and B from loosening.

4.9. Inspection of rubber belt.

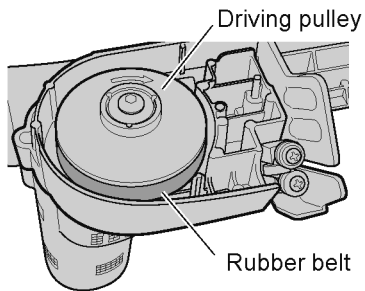

If the rubber ring is found to be slack or damaged during the replacement of saw blade, replace the rubber belt. If the rubber ring is slack or damaged, the saw blade may rotate unstably or extend out.

4.10. How to remove the Rubber belt.

***Replace the idler/driving pulley at the same time when replacing the rubber belt.**

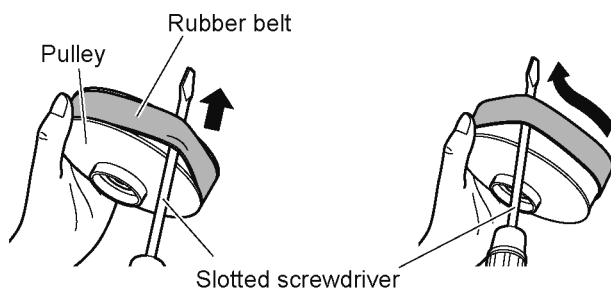

1. Insert the tip of a slotted screwdriver between the pulley and rubber belt, and raise and move the rubber belt to dislodge it from the groove on the pulley.

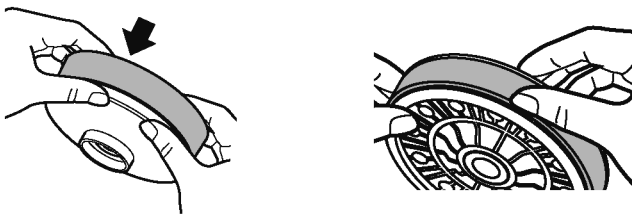

○ The rubber belt is properly positioned in the groove on the pulley.

✗ The rubber belt is not correctly positioned in the groove on the pulley.

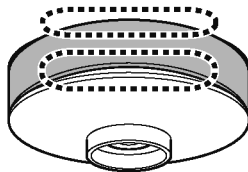
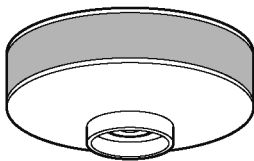

4.11. Wiring and Assembly Points.

Tighten the screws after assembling the parts completely.

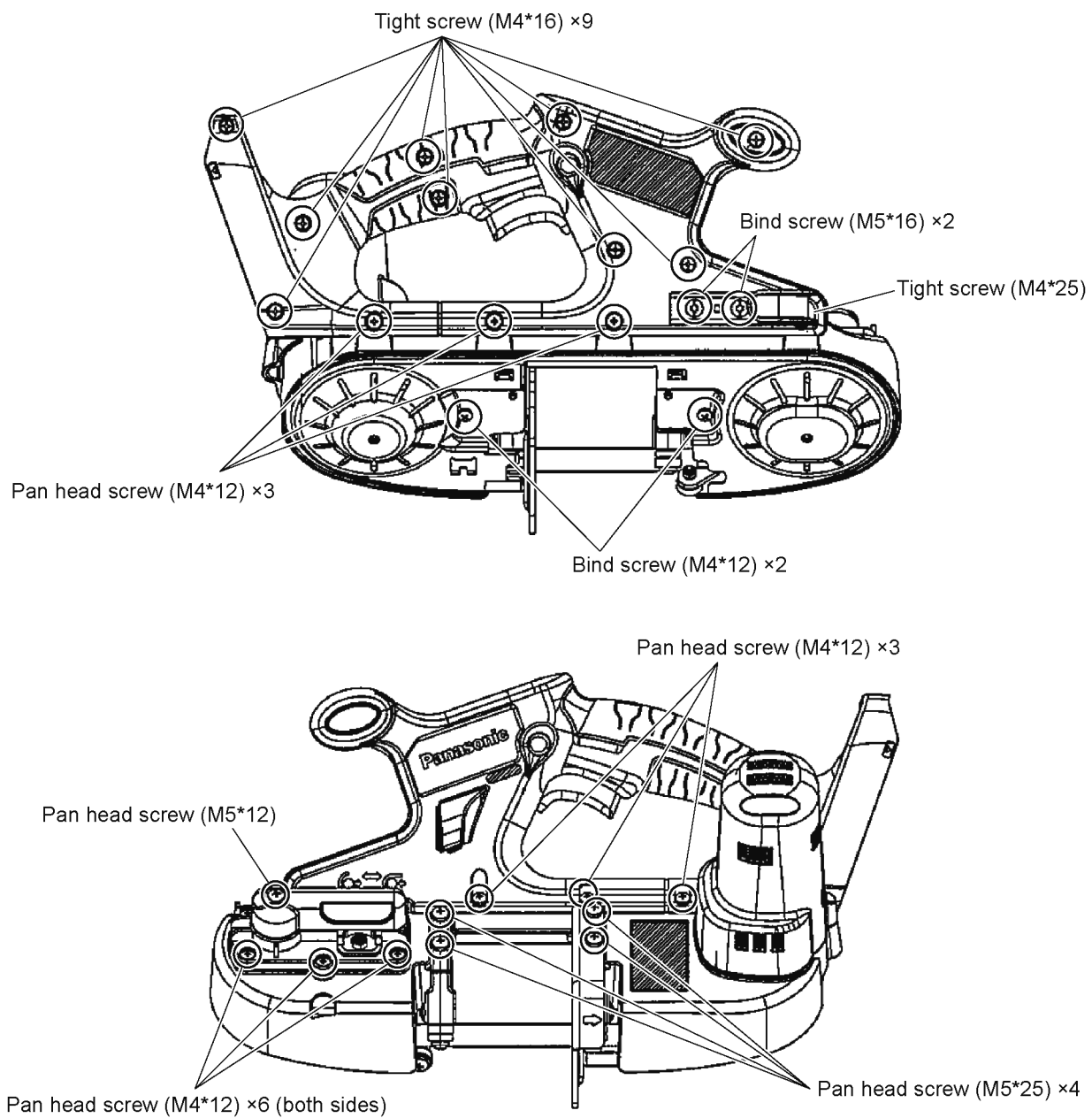

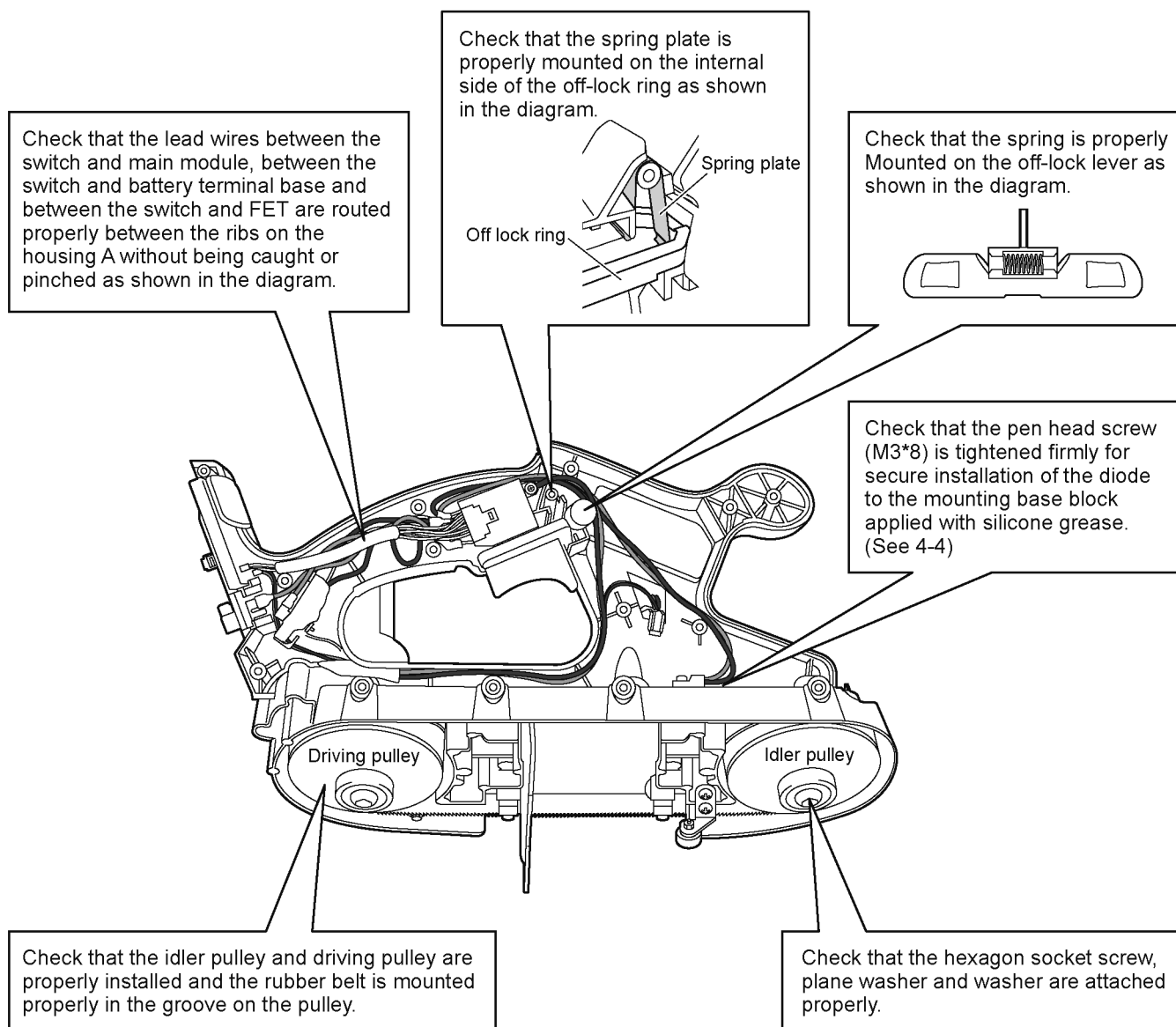

5 Exploded View and Replacement Parts List

Model No. : EY45A5 Exploded View

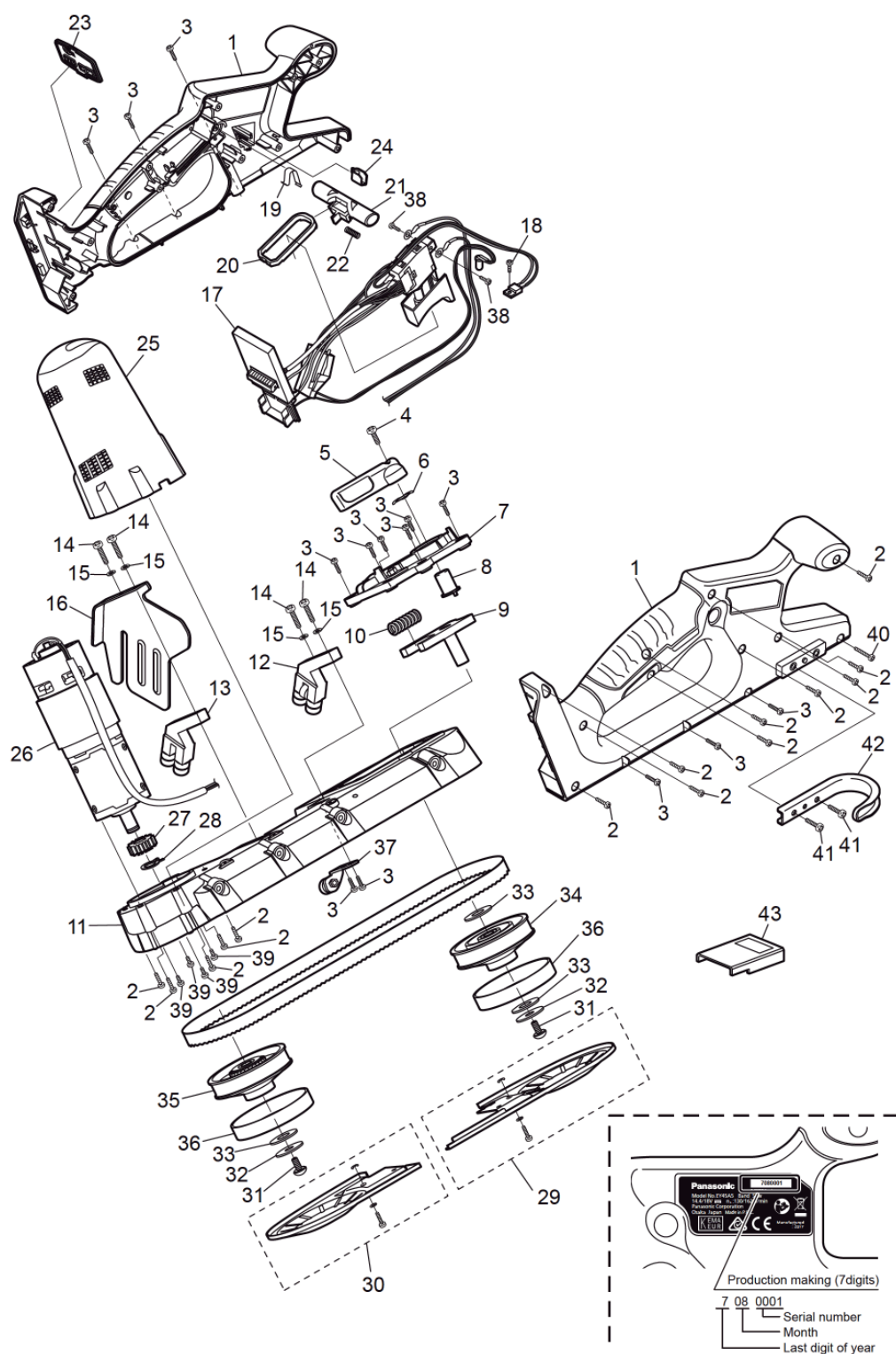

Model No. : EY45A5 Parts List

Change	Safety	Ref. No.	Part No.	Part Name & Description	Q'ty	Remarks
		1	WEY45A5K3078	HOUSING AB ASSEMBLY	1	(FOR EUROPE/OCEANIA)
		2	WEY45A5K9127	TIGHT SCREW	14	(M4*16) , (14PCS/PK)
		3	WEY45A5K6237	PAN HEAD SCREW	14	(M4*12) , (14PCS/PK)
		4	WEY45A5K6087	PAN HEAD SCREW	1	(M5*12)
		5	WEY45A5H1567	LEVER	1	
		6	WEY45A5K6147	WAVE WASHER	1	
		7	WEY45A5K4727	COVER PLATE ASSEMBLY	1	
		8	WEY45A5K1377	SHAFT ASSEMBLY	1	
		9	WEY45A5S4347	SLIDE BLOCK ASSEMBLY	1	
		10	WEY45A5S0167	SPRING	1	
		11	WEY45A5S4998	MOUNTING BASE BLOCK	1	
		12	WEY45A5K0807	GUIDE A ASSEMBLY	1	
		13	WEY45A5K0817	GUIDE B ASSEMBLY	1	
		14	WEY45A5K6427	PAN HEAD SCREW	4	(M5*25) , (4PCS/PK)
		15	WEY45A5K6447	SPRING WASHER	4	(4PCS/PK)
		16	WEY45A5K0887	FENCE	1	
		17	WEY45A5L2107	SWITCH AND MAIN MODULE	1	
		18	WEY45A5L6367	PAN HEAD SCREW	1	(M3*8) , (5PCS/PK)
		19	WEY45A5L0187	SPRING PLATE	1	
		20	WEY45A5W0987	OFF LOCK RING	1	
		21	WEY45A5H3597	OFF LOCK LEVER	1	
		22	WEY45A5L0197	SPRING	1	
		23	WEY45A5K3958	CONTROL PANEL ASSEMBLY	1	
		24	WEY45A5X3097	LED COVER	1	
		25	WEY45A5K3747	MOTOR HOUSING	1	
		26	WEY45A5L1008	MOTOR AND GEAR CASE ASSY	1	
		27	WEY45A5L1417	TRANSMITTING GEAR	1	
		28	WEY45A5L6777	STOP RING	1	
		29	WEY45A5K3107	UPPER GUARD ASSEMBLY	1	
		30	WEY45A5K3117	LOWER GUARD ASSEMBLY	1	
		31	WEY45A5K6577	HEXAGON SOCKET SCREW	2	(M8*14) , (2PCS/PK)
		32	WEY45A5L6667	PLAIN WASHER	2	(2PCS/PK)
		33	WEY45A5L6707	WASHER	3	(3PCS/PK)
		34	WEY45A5K1307	IDLER PULLEY	1	
		35	WEY45A5K1317	DRIVING PULLEY	1	
		36	WEY45A5K1097	RUBBER BELT	2	(2PCS/PK)
		37	WEY45A5K1897	GUIDE C ASSEMBLY	1	
		38	WEY45A5K6127	PAN HEAD SCREW	2	(M3*6) , (2PCS/PK)
		39	WEY45A5L6047	PAN HEAD SCREW	4	(M4*8) , (4PCS/PK)
		40	WEY45A5K9077	TIGHT SCREW	1	(M4*25) , (5PCS/PK)
		41	WEY45A5L6307	BIND SCREW	2	(M5*16) , (2PCS/PK)
		42	WEY45A5K3767	HOOK	1	
		43	WEY9L40R2788	BATTERY PACK COVER	1	
		-	WEY9664K7018	TOOL CASE	1	
		-	WEY45A5K8108	OPERATING INSTRUCTIONS	1	
		-	WEY6705X5527	SUNLIGHT GREASE	1	